

PYG[®] 鵬銀精密

PYG Ball Screw



1-1 Ball Screw Selection Procedure

Load, speed acceleration, max. travel length, positioning accuracy, required life, load condition (vibration, impact, atmosphere), lubrication.

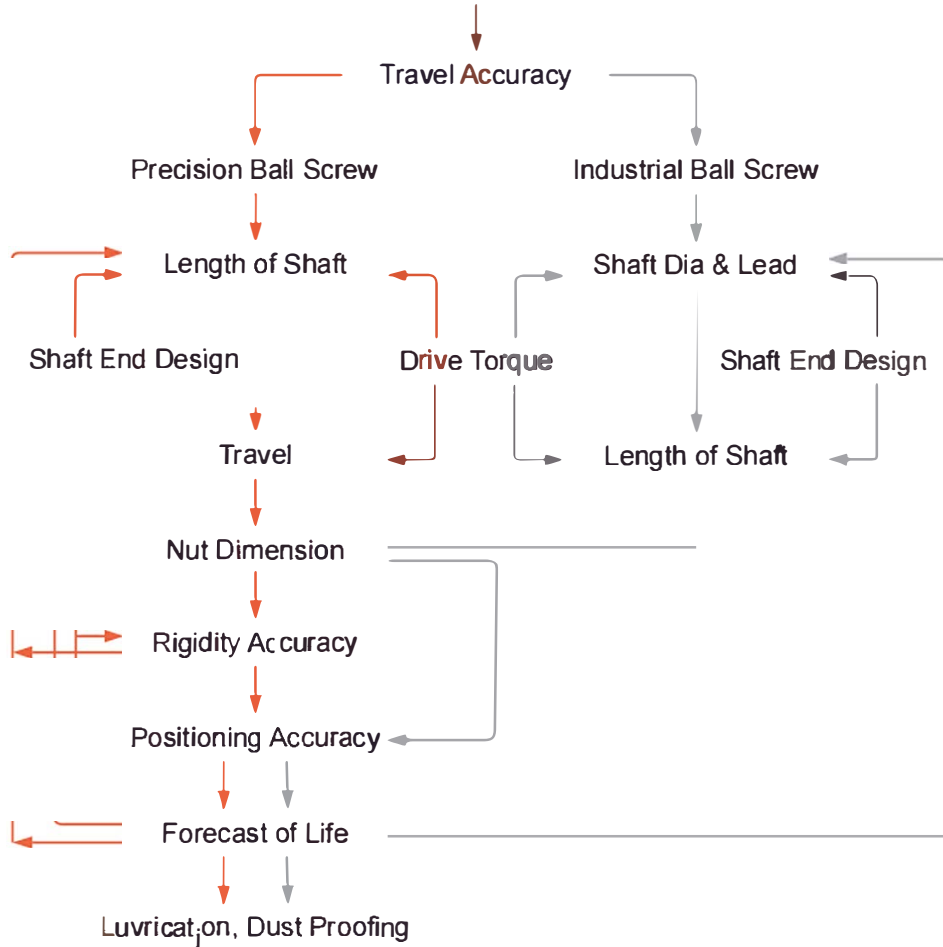

Accuracy (C05)
 Screw Shaft Design (C11)
 Drive Torque (C17)
 Nut Design (C19)

Rigidity (C21)
 Positioning Accuracy (C24)
 Life Design (C26)
 Lubrication and safety design (C32)

1-2 Accuracy

Table 1.2.1 Mean Travel Deviation ($\pm E$) and Travel Variation (e) (JIS B 1192)

Unit : μm

Grade		C0		C1		C2		C3		C5		C7	C10
Over	Incl.	$\pm E$	e	$\pm E$	e	$\pm E$	e	$\pm E$	e	$\pm E$	e	e	e
100	100	3	3	3.5	5	5	7	8	8	18	18	$\pm 50/300\text{mm}$	$\pm 210/300\text{mm}$
	200	3.5	3	4.5	5	7	7	10	8	20	18		
200	315	4	3.5	6	5	8	7	12	8	23	18		
315	400	5	3.5	7	5	9	7	13	10	25	20		
400	500	6	4	8	5	10	7	15	10	27	20		
500	630	6	4	9	6	11	8	16	12	30	23		
630	800	7	5	10	7	13	9	18	13	35	25		
800	1000	8	6	11	8	15	10	21	15	40	27		
1000	1250	9	6	13	9	18	11	24	16	46	30		
1250	1600	11	7	15	10	21	13	29	18	54	35		
1600	2000			18	11	25	15	35	21	65	40		
2000	2500			22	13	30	18	41	24	77	46		
2500	3150			26	15	36	21	50	29	93	54		
3150	4000			30	18	44	25	60	35	115	65		
4000	5000					52	30	72	41	140	77		
5000	6300					65	36	90	50	170	93		
6300	8000							110	60	210	115		
8000	10000									260	140		
10000	12500									320	170		

Table 1.2.2 International standard of accuracy grade for ball screw

Unit : μm

Grade		Ground					Ground Rolled		
		C0	C1	C2	C3	C5	C5	C7	C10
E ₃₀₀	ISO, DIN		6		12	23	23	52	210
	JIS	3.5	5		8	18	18	50	210
	PYG MOTION	3.5	5	7	8	18	23	50	210

■ Axial play of **PYG MOTION's** precision ball screw is shown below

Table 1.2.3 Classification of Axial Play

Grade	P0	P1	P2	P3	P4
Axial Play	Yes	No	No	No	No
Preload	No	No	Light	Medium	Heavy

1-3 Accuracy

■ 1-3-1 Definition of Mounting Accuracy and Tolerance on Ball Screw

The main items of the mounting accuracy of ball screw are listed in below

- (1) Periphery run-out of the supporting part of the screw shaft to the screw groove
- (2) Concentricity of a mounting portion of the shaft to the adjacent ground portion of the screw shaft
- (3) Perpendicularity of the shoulders to the adjacent ground portion of the screw shaft
- (4) Perpendicularity of the nut flange to the axis of the screw shaft
- (5) Concentricity of the ball nut diameter to the screw groove
- (6) Parallelism of the mounting surface of a ball nut to the screw groove
- (7) Total run-out of the screw shaft to the axis of the screw shaft

All **PYG MOTION** ball screws are manufactured, inspected and guaranteed to be within specifications

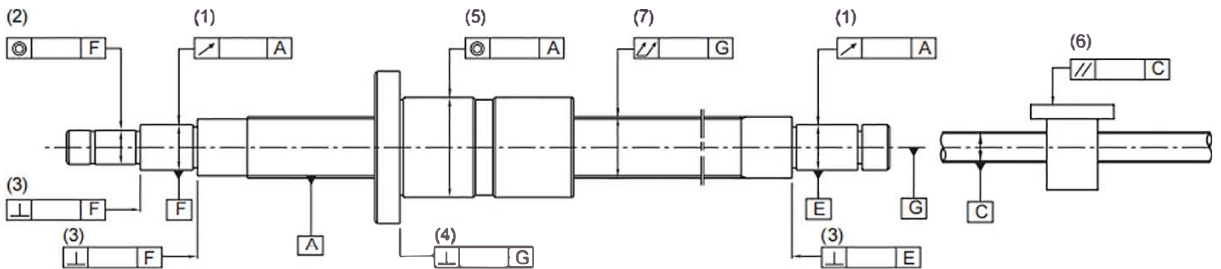





Fig 1.3.2 Mounting Accuracy and Tolerance

1-4 Cautions About Use of Ball Screws

■ 1-4-1 Assembling the Ball Screws

If rolled ball nut is shipped un-assembled please follow the procedure as b

Table 1.4.2 Procedure

	
(1) Remove the band.	(2) Attached the mandrel towards machine ends.
	
(3) Rotate the ball nut into the screw along the thread.	(4) Ensure that the ball nut is fully inserted before remove the mandrel.

■ 1-4-2 Machining Specifications

(1) For the Ball Screws with internal or end cap type circulation ball nut, it is required to have at least one end with complete thread to the end of screw, it is also required to have the journal area is with diameter to be smaller than the diameter of thread root as Fig 1.10.4 shown

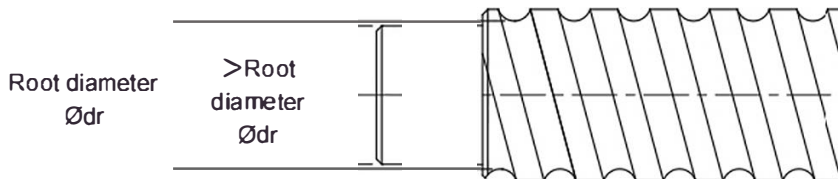

Fig 1.4.3 For Internal Circulation

(2) The thread on screw shaft are hardened by induction hardening. It shall cause about 10~20mm at both ends journal purpose. The unhardened area will be labeled

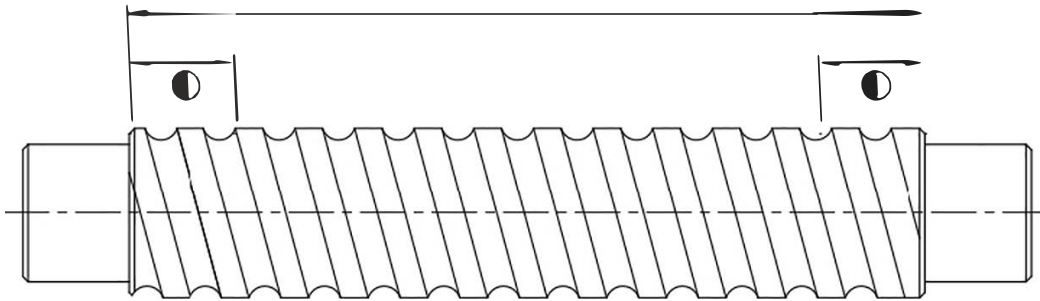

Fig 1.4.4 Harden Area

Table 1 Screw specification

單位: mm

外徑 d	型號		導程精度等級	螺紋方向	牙口數	標準型 螺桿編碼	適用螺帽 型式	轉造螺桿 最長長度
	導程 l	珠徑 Da		L: 左 / R: 右				
40	5	3.175	C10、C7、C5	R/L	1	SCR04005	V、I、U、S、H	6000
	10	6.35	C10、C7	R/L	1	SCR04010	V、I、U	
	20	6.35	C10、C7	R	2	SCR04020	V	
	40	6.35	C10、C7	R	4	SCR04040	Y	
	80	6.35	C10、C7	R	8	CR04080	Y	
50	5	3.175	C10、C7、C5	R	1	SCR05005	V、S、H	6000
	10	6.35	C10、C7、C5	R/L	1	SCR05010	V、I、U	
	20	9.525	C10、C7	R	1	SCR05020	V	
	50	7.938	C10、C7	R	4	SCR05050	Y	
	100	7.938	C10、C7	R	8	SCR050100	Y	
63	10	6.35	C10、C7、C5	R	1	SCR06310	V、I、U	7000
	20	9.525	C10、C7	R	1	SCR06320	V、U	
80	10	6.35	C10、C7、C5	R	1	SCR08010	V、I、U	7000
	20	9.525	C10、C7	R	1	SCR08020	V、U	

Table 2 S type screw size(Ø12 ~ 50)

單位: mm

外徑 d	型號		導程精度等級	螺紋方向	牙口數	標準型 螺桿編碼	適用螺帽 型式	轉造螺桿 最長長度
	導程 l	珠徑 Da		L: 左 / R: 右				
12	10	2.5	C10、C7、C5	R	2	SSR01210	S	3000
16	5	2.778	C10、C7、C5	R	1	SSR01605	S、H	3000
	10	2.778	C10、C7、C5	R	2	SSR01610	S、H	
	16	2.778	C10、C7、C5	R	4	SSR01616	S、H	
	20	2.778	C10、C7、C5	R	4	SSR01620	S	
20	10	3.175	C10、C7、C5	R	2	SSR02010	S、H	3000
25	10	3.175	C10、C7、C5	R	2	SSR02510	S、H	6000
	25	3.175	C10、C7	R	4	SSR02525	S、H	
32	10	3.969	C10、C7、C5	R	1	SSR03210	S、H	6000
	20	3.969	C10、C7	R	2	SSR03220	S、H	
	32	3.969	C10、C7	R	4	SSR03232	S	
40	10	6.35	C10、C7	R	1	SSR04010	S、H	6000
	20	6.35	C10、C7、C5	R	2	SSR04020	S	
	40	6.35	C10、C7	R	4	SSR04040	S	
50	10	6.35	C10、C7	R	1	SSR05010	S、H	6000
	20	6.35	C10、C7	R	2	SSR05020	S	
	50	6.35	C10、C7	R	4	SSR05050	S	

2-2 SFDC Series Specification

SFDC系列尺寸表

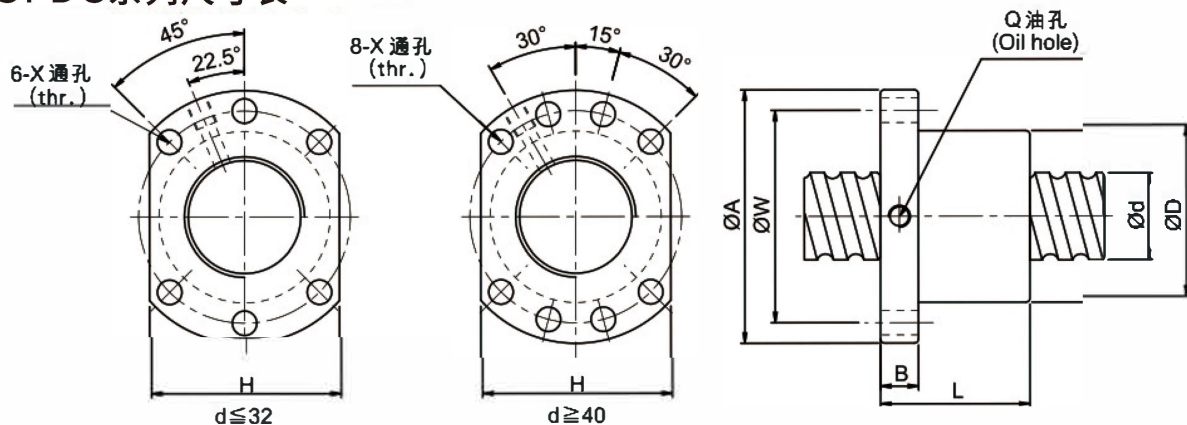

單位: mm

公稱型號 Model no.	軸徑 d	導程 l	珠徑 Da	螺帽尺寸								動額定 負荷 Ca	靜額定 負荷 Coa	剛性 kgf/ µm		
				D	A	B	L	W	H	X	Q				n	
SFDCR2812-2.8	28	12	6.35	54	87	16	65.5	72	9	69	M8x1	2.8x1	2752	5746	43	
SFDCR2812-3.8		12	6.35	54	87	16	77.5	72	9	69	M8x1	3.8x1	3579	7799	59	
SFDCR2812-4.8		12	6.35	54	87	16	89.5	72	9	69	M8x1	4.8x1	4375	9851	74	
SFDCR2816-2.8		16	4.762	48	74	12	74.5	60	6.6	60	M6x1	2.8x1	1855	3589	41	
SFDCR2816-3.8		16	4.762	48	74	12	90.5	60	6.6	60	M6x1	3.8x1	2412	4871	55	
SFDCR2816-4.8		16	4.762	48	74	12	106.5	60	6.6	60	M6x1	4.8x1	2949	6153	70	
SFDCR3210-2.8	32	10	4.762	58	91	18	57	76	9	68	M8x1	2.8x1	1955	4041	45	
SFDCR3210-3.8		10	4.762	58	91	18	67	76	9	68	M8x1	3.8x1	2542	5485	61	
SFDCR3210-4.8		10	4.762	58	91	18	77	76	9	68	M8x1	4.8x1	3107	6928	77	
SFDCR3205-2.8		5	3.175	50	87	16	39	72	9	69	M8x1	2.8x1	1118	2653	43	
SFDCR3205-3.8		5	3.175	50	87	16	44	72	9	69	M8x1	3.8x1	1454	3600	58	
SFDCR3205-4.8		5	3.175	50	87	16	49	72	9	69	M8x1	4.8x1	1778	4547	73	
SFDCR3212-2.8		12	4.762	53	87	16	40.5	72	9	69	M8x1	2.8x1	1956	4049	45	
SFDCR3212-3.8		12	4.762	53	87	16	64.5	72	9	69	M8x1	3.8x1	2544	5496	61	
SFDCR3212-4.8		12	4.762	53	87	16	88.5	72	9	69	M8x1	4.8x1	3110	6942	77	
SFDCR3216-2.8		16	6.35	57	87	16	77.5	72	9	69	M8x1	2.8x1	2915	11226	48	
SFDCR3216-3.8		16	6.35	57	87	16	93.5	72	9	69	M8x1	3.8x1	3790	8887	66	
SFDCR3216-4.8		16	6.35	57	87	16	109.5	72	9	69	M8x1	4.8x1	4634	6549	83	
SFDCR4006-2.8	40	6	3.969	58	91	18	45.5	76	9	68	M8x1	2.8x1	1671	4010	52	
SFDCR4006-3.8		6	3.969	58	91	18	51.5	76	9	68	M8x1	3.8x1	2172	5618	70	
SFDCR4006-4.8		6	3.969	58	91	18	57.5	76	9	68	M8x1	4.8x1	2656	7096	88	
SFDCR4010-2.8		10	6.35	65	95	18	62.5	80	9	72	M8x1	2.8x1	3192	9048	57	
SFDCR4010-3.8		10	6.35	65	95	18	72.5	80	9	72	M8x1	3.8x1	4150	10922	77	
SFDCR4010-4.8		10	6.35	65	95	18	82.5	80	9	72	M8x1	4.8x1	5074	13797	97	
SFDCR4012-2.8		12	6.35	65	95	18	65.5	80	9	72	M8x1	2.8x1	3194	8058	57	
SFDCR4012-3.8		12	6.35	65	95	18	77.5	80	9	72	M8x1	3.8x1	4153	10936	77	
SFDCR4012-4.8		12	6.35	65	95	18	89.5	80	9	72	M8x1	4.8x1	5077	13815	97	
SFDCR4016-2.8		16	6.35	65	95	18	76.5	80	9	72	M8x1	2.8x1	3198	8085	57	
SFDCR4016-3.8		16	6.35	65	95	18	92.5	80	9	72	M8x1	3.8x1	4159	10972	77	
SFDCR4016-4.8		16	6.35	65	95	18	108.5	80	9	72	M8x1	4.8x1	5084	13860	97	
SFDCR5010-2.8		50	10	6.35	75	118	18	62.5	100	11	92	M8x1	2.8x1	3509	9982	67
SFDCR5010-3.8			10	6.35	75	118	18	72.5	100	11	92	M8x1	3.8x1	4563	13547	90
			10	6.35	75	118	18	82.5	100	11	92	M8x1	4.8x1	5578	17112	114

DFDC Series Specification

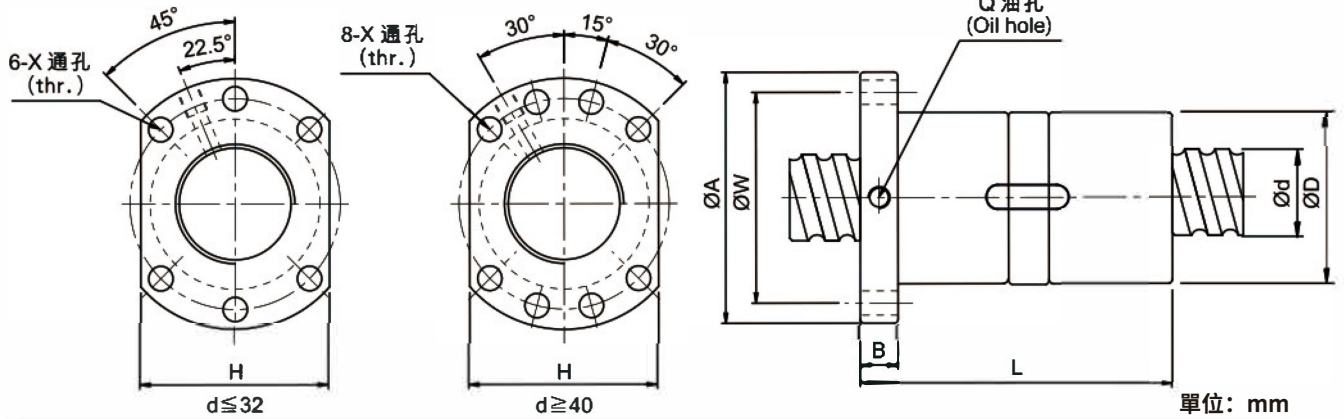

公稱型號 Model no.	軸徑 d	導程 l	珠徑 Da	螺帽尺寸									動額定 負荷 Ca	靜額定 負荷 Coa	剛性 kgf/ µm
				D	A	B	L	W	H	X	Q	n			
DFDCR2812-2.8	28	12	6.35	54	87	16	125.5	72	69	9	M8x1	2.8x1	2752	5746	66
DFDCR2812-3.8		12	6.35	54	87	16	149.5	72	69	9	M8x1	3.8x1	3579	7799	90
DFDCR2812-4.8		12	6.35	54	87	16	173.5	72	69	9	M8x1	4.8x1	4375	9851	113
DFDCR2816-2.8		16	4.762	48	74	12	143	60	60	6.6	M6x1	2.8x1	1855	3589	63
DFDCR2816-3.8		16	4.762	48	74	12	175	60	60	6.6	M6x1	3.8x1	2412	4871	85
DFDCR2816-4.8		16	4.762	48	74	12	207	60	60	6.6	M6x1	4.8x1	2949	6153	108
DFDCR3210-2.8	32	10	4.762	58	91	18	107.5	76	68	9	M8x1	2.8x1	1955	4041	69
DFDCR3210-3.8		10	4.762	58	91	18	127.5	76	68	9	M8x1	3.8x1	2542	5485	94
DFDCR3210-4.8		10	4.762	58	91	18	147.5	76	68	9	M8x1	4.8x1	3107	6928	119
DFDCR3205-2.8		5	3.175	50	87	16	71.5	72	69	9	M8x1	2.8x1	1118	2653	52
DFDCR3205-3.8		5	3.175	50	87	16	81.5	72	69	9	M8x1	3.8x1	1454	3600	71
DFDCR3205-4.8		5	3.175	50	87	16	91.5	72	69	9	M8x1	4.8x1	1778	4547	90
DFDCR3212-2.8	32	12	4.762	53	87	16	124.5	72	69	9	M8x1	2.8x1	1956	4049	69
DFDCR3212-3.8		12	4.762	53	87	16	148.5	72	69	9	M8x1	3.8x1	2544	5496	94
DFDCR3212-4.8		12	4.762	53	87	16	172.5	72	69	9	M8x1	4.8x1	3110	6942	119
DFDCR3216-2.8		16	6.35	57	87	16	149.5	72	69	9	M8x1	2.8x1	2915	11226	74
DFDCR3216-3.8		16	6.35	57	87	16	181.5	72	69	9	M8x1	3.8x1	3790	8887	100
DFDCR3216-4.8		16	6.35	57	87	16	213.5	72	69	9	M8x1	4.8x1	4634	6549	126
DFDCR4006-2.8	40	6	3.969	58	91	18	60.5	76	68	9	M8x1	2.8x1	1671	4010	80
DFDCR4006-3.8		6	3.969	58	91	18	84.5	76	68	9	M8x1	3.8x1	2172	5618	108
DFDCR4006-4.8		6	3.969	58	91	18	108.5	76	68	9	M8x1	4.8x1	2656	7096	136
DFDCR4010-2.8		10	6.35	65	95	18	117.5	80	72	9	M8x1	2.8x1	3192	9048	87
DFDCR4010-3.8		10	6.35	65	95	18	137.5	80	72	9	M8x1	3.8x1	4150	10922	118
DFDCR4010-4.8		10	6.35	65	95	18	157.5	80	72	9	M8x1	4.8x1	5074	13797	149
DFDCR4012-2.8	40	12	6.35	65	95	18	125.5	80	72	9	M8x1	2.8x1	3194	8058	87
DFDCR4012-3.8		12	6.35	65	95	18	149.5	80	72	9	M8x1	3.8x1	4153	10936	118
DFDCR4012-4.8		12	6.35	65	95	18	173.5	80	72	9	M8x1	4.8x1	5077	13815	149
DFDCR4016-2.8		16	6.35	65	95	18	148.5	80	72	9	M8x1	2.8x1	3198	8085	87
DFDCR4016-3.8		16	6.35	65	95	18	180.5	80	72	9	M8x1	3.8x1	4159	10972	118
DFDCR4016-4.8		16	6.35	65	95	18	212.5	80	72	9	M8x1	4.8x1	5084	13860	149
DFDCR5010-2.8	50	10	6.35	75	118	18	117.5	100	92	11	M8x1	2.8x1	3509	9982	104
DFDCR5010-3.8		10	6.35	75	118	18	137.5	100	92	11	M8x1	3.8x1	4563	13547	141
DFDCR5010-4.8		10	6.35	75	118	18	157.5	100	92	11	M8x1	4.8x1	5578	17112	178

SFY Series Specification

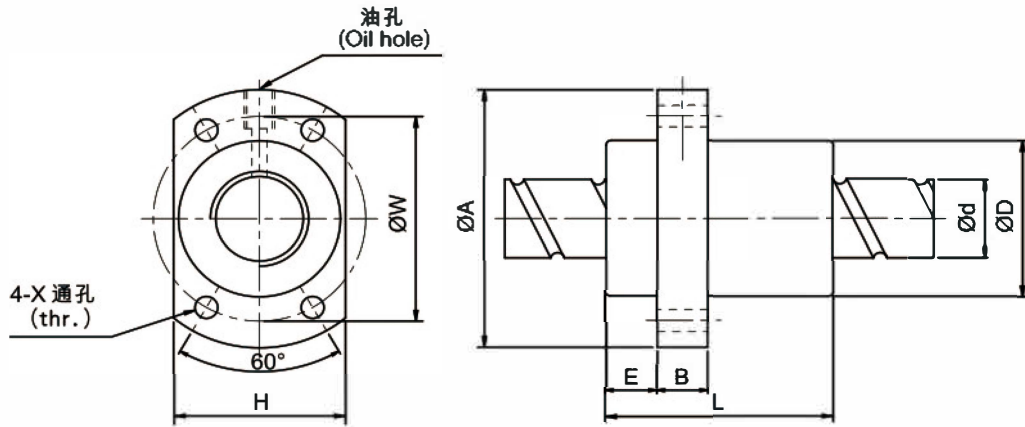

單位: mm

公稱型號 Model no.	軸徑 d	導程 l	珠徑 Da	螺帽尺寸										動額定 負荷 Ca	靜額定 負荷 Coa
				D	A	E	B	L	W	H	X	Q	n		
SFYR1616-3.6	16	16	2.778	32	53	10.1	10	45	42	34	4.5	M6x1	1.8x2	1073	2551
SFYR2020-3.6	20	20	3.175	39	62	13	10	52	50	41	5.5	M6x1	1.8x2	1387	3515
SFYR2040-1.6	40	40	3.175	39	62	13	10	48	50	41	5.5	M6x1	0.8x2	653	1597
SFYR2550-1.6	50	50	3.969	47	74	15	12	58	60	49	6.6	M6x1	0.8x2	976	2495
SFYR2525-3.6	25	25	3.969	47	74	15	12	64	60	49	6.6	M6x1	1.8x2	2074	5495
SFYR3232-3.6	32	32	4.762	58	92	17	12	78	74	60	9	M6x1	1.8x2	3021	8690
SFYR4040-3.6	40	40	6.35	73	114	19.5	15	99	93	75	11	M6x1	1.8x2	4831	14062
SFYR5050-3.6	50	50	7.938	90	135	21.5	20	117	112	92	14	M6x1	1.8x2	7220	21974

SFE Series Specification

公稱型號 Model no.	軸徑 d	導程 l	珠徑 Da	螺帽尺寸										動額定 負荷 Ca	靜額定 負荷 Coa
				D	A	E	B	L	W	H	X	Q	n		
SFE01616-3.6	16	16	2.778	32	53	10.1	10	45	42	34	4.5	M6x1	1.8x2	1073	2551
SFE02020-3.6	20	20	3.175	39	62	11.5	10	55	50	41	5.5	M6x1	1.8x2	1387	3515
SFE02525-3.6	25	25	3.969	47	74	13	12	57	60	49	6.6	M6x1	1.8x2	2074	5495
SFE03232-3.6	32	32	4.762	58	92	16	12	82	74	60	9	M6x1	1.8x2	3021	8690
SFE04040-3.6	40	40	6.35	73	114	19	15	100	93	75	11	M6x1	1.8x2	4831	14062
SFE05050-3.6	50	50	7.938	90	135	21.5	20	125	112	92	14	M6x1	1.8x2	7220	21974

SFS Series Specification

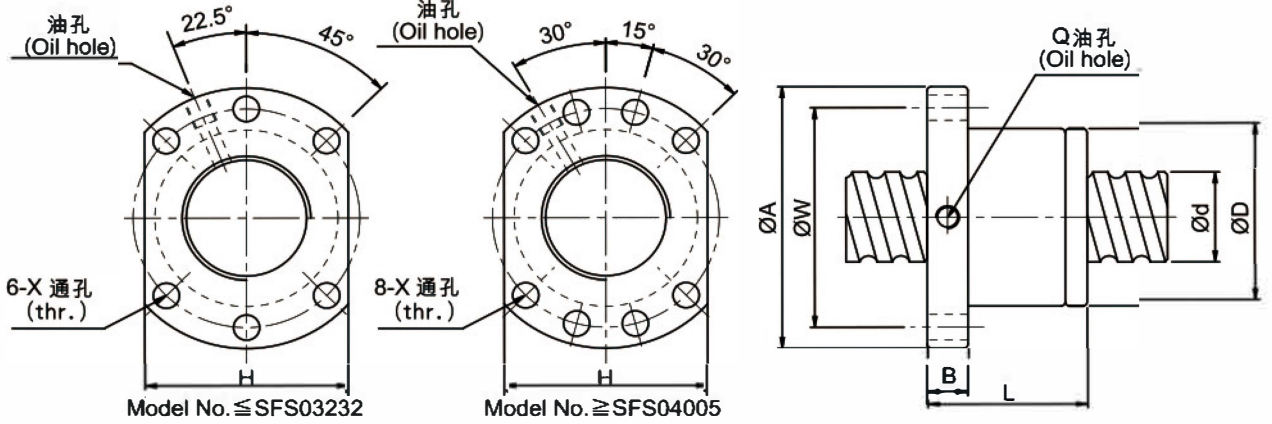

單位: mm

公稱型號 Model no.	軸徑 d	導程 l	珠徑 Da	螺帽尺寸									動額定 負荷 Ca	靜額定 負荷 Coa
				D	A	B	L	W	H	X	Q	n		
SFSR1205-2.8	12	5	2.5	24	40	10	31	32	30	4.5	M6x1	2.8x1	661	1316
SFSR1210-2.8		10	2.5	24	40	10	48.5	32	30	4.5	M6x1	2.8x1	642	1287
SFSR1605-3.8		15	5	2.778	28	48	10	38	38	40	5.5	M6x1	3.8x1	1112
SFSR1610-2.8	10		2.778	28	48	10	47	38	40	5.5	M6x1	2.8x1	839	1821
SFSR1616-1.8	16		2.778	28	48	10	45	38	40	5.5	M6x1	1.8x1	552	1137
SFSR1616-2.8	16		2.778	28	48	10	61	38	40	5.5	M6x1	2.8x1	808	1769
SFSR1620-1.8	20		2.778	28	48	10	57	38	40	5.5	M6x1	1.8x1	554	1170
SFSR2005-3.8	20	5	3.175	36	58	10	40	47	44	6.6	M6x1	3.8x1	1484	3681
SFSR2010-3.8		10	3.175	36	58	10	60	47	44	6.6	M6x1	3.8x1	1516	3833
SFSR2020-1.8		20	3.175	36	58	10	57	47	44	6.6	M6x1	1.8x1	764	1758
SFSR2020-2.8		20	3.175	36	58	10	77	47	44	6.6	M6x1	2.8x1	1118	2734
SFSR2505-3.8	25	5	3.175	40	62	10	40	51	48	6.6	M6x1	3.8x1	1650	4658
SFSR2510-3.8		10	3.175	40	62	12	65	51	48	6.6	M6x1	3.8x1	1638	4633
SFSR2520-3.8		20	3.175	40	62	12	72	51	48	6.6	M6x1	2.8x1	1206	2695
SFSR2525-1.8		25	3.175	40	62	12	70	51	48	6.6	M6x1	1.8x1	843	2199
SFSR2525-2.8		25	3.175	40	62	12	95	51	48	6.6	M6x1	2.8x1	1232	3421
SFSR3205-3.8	32	5	3.175	50	80	12	42	65	62	9	M8x1	3.8x1	1839	6026
SFSR3210-3.8		10	3.969	50	80	13	62	65	62	9	M8x1	3.8x1	2460	7255
SFSR3220-1.8	31	20	3.969	50	80	12	80	65	62	9	M8x1	2.8x1	1907	5482
SFSR3232-2.8		32	3.969	50	80	13	84	65	62	9	M8x1	1.8x1	1257	3426
SFSR3232-2.8		32	3.969	50	80	13	116	65	52	9	M8x1	2.8x1	1838	2329
SFSR4005-3.8	40	5	3.175	63	93	15	45	78	70	9	M8x1	3.8x1	2018	7589
SFSR4010-3.8		10	6.35	63	93	14	63	78	70	9	M8x1	3.8x1	5035	13943
SFSR4020-2.8		38	20	6.35	63	93	14	82	78	70	9	M8x1	2.8x1	3959
SFSR4040-1.8	40		6.35	63	93	15	105	78	70	9	M8x1	1.8x1	2585	6648
SFSR4040-2.8	40		6.35	63	93	15	145	78	70	9	M8x1	2.8x1	3780	10341
SFSR5005-3.8	50	5	3.175	75	110	15	45	93	85	11	M8x1	3.8x1	2207	9542
SFSR5010-3.8		10	6.35	75	110	18	68	93	85	11	M8x1	3.8x1	5638	17852
SFSR5020-3.8	48	20	6.35	75	110	18	108	93	85	11	M8x1	3.8x1	5749	18458
SFSR5050-1.8		50	6.35	75	110	18	125	93	85	11	M8x1	1.8x1	2947	8749
SFSR5050-2.8		50	6.35	75	110	18	175	93	85	11	M8x1	2.8x1	4308	13610

SFI Series Specification

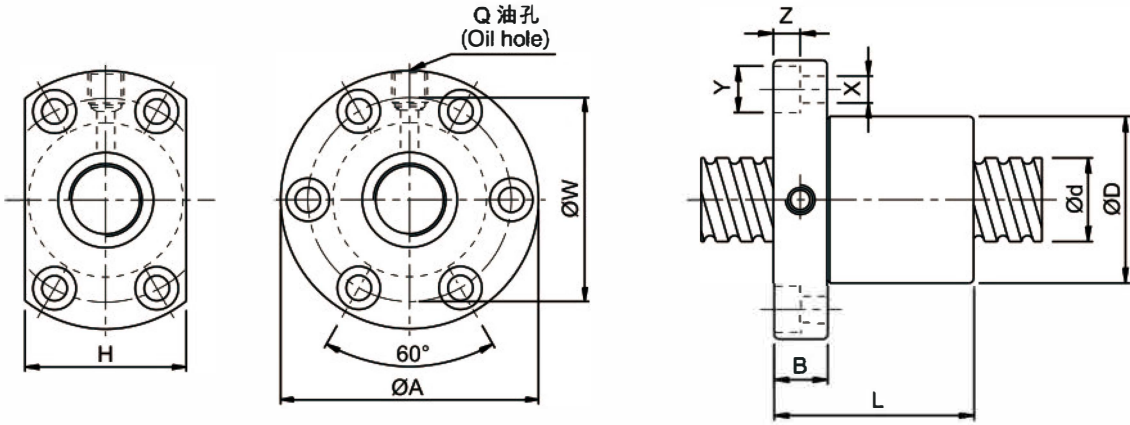

單位: mm

公稱型號 Model no.	軸徑 d	導程 l	珠徑 Da	螺帽尺寸										動額定 負荷 Ca	靜額定 負荷 Coa	
				D	A	B	L	W	H	X	Y	Z	Q			n
☆ SFIR1605-4	16	5	3.175	30	49	10	50	39	34	4.5	8	4.5	M6x1	1X4	888	1525
☆ SFIR1610-3		10	3.175	34	58	10	57	45	34	5.5	9.5	5.5	M6x1	1X3	716	1232
☆ SFIR2005-4	20	5	3.175	34	57	11	51	45	40	5.5	9.5	5.5	M6x1	1X4	999	1994
☆ SFIR2505-4		5	3.175	40	63	11	51	51	46	5.5	9.5	5	M8x1	1X4	1119	2581
☆ SFIR2510-4	25	10	4.762	46	72	12	85	58	52	6.5	11	6.5	M8x1	1X4	1903	3695
☆ SFIR3205-4		5	3.175	46	72	12	52	58	52	6.5	11	6.5	M8x1	1X4	1264	3402
☆ SFIR3210-4	32	10	6.35	54	88	15	90	70	62	9	14	8.5	M8x1	1X4	2092	6101
☆ SFIR4005-4		5	3.175	56	90	15	55	72	64	9	14	8.5	M8x1	1X4	1407	4341
☆ SFIR4010-4	40	10	6.35	62	104	18	93	82	70	11	17.5	11	M8x1	1X4	3480	7779
☆ SFIR5010-4		20	6.35	72	114	18	93	92	82	11	17.5	11	M8x1	1X4	3898	10325
☆ SFIR6310-4	63	10	6.35	85	131	22	98	107	95	14	20	13	M8x1	1X4	4401	13611
☆ SFIR8010-4		10	6.35	105	150	22	98	127	115	14	20	13	M8x1	1X4	4900	17366

DFI Series Specification

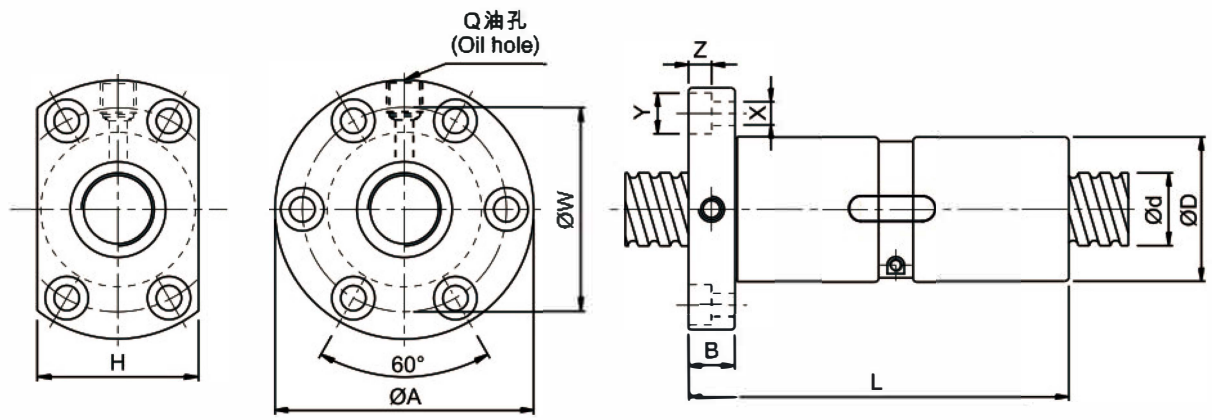

單位: mm

公稱型號 Model no.	軸徑 d	導程 l	珠徑 Da	螺帽尺寸										動額定 負荷 Ca	靜額定 負荷 Coa	
				D	A	B	L	W	H	X	Y	Z	Q			n
☆ DFIR1605-4	16	5	3.175	30	49	10	10	39	34	4.5	8	4.5	M6x1	1X4	888	1525
☆ DFIR2005-4	20	5	3.175	34	57	11	101	45	40	5.5	9.5	5.5	M6x1	1X4	999	1994
☆ DFIR2505-4	25	5	3.175	40	63	11	101	51	46	5.5	9.5	5.5	M6x1	1X4	1119	2581
☆ DFIR2510-4		10	4.762	46	72	12	145	58	52	6.5	11	6.5	M8x1	1X4	1903	3695
☆ DFIR3205-4	32	5	3.175	46	72	12	102	58	52	6.5	11	6.5	M8x1	1X4	1264	3402
☆ DFIR3210-4		10	6.35	54	88	15	162	70	62	9	14	8.5	M8x1	1X4	2092	6101
☆ DFIR4005-4	40	5	3.175	56	90	15	105	72	64	9	14	8.5	M8x1	1X4	1407	4341
☆ DFIR4010-4		10	6.35	62	104	18	165	82	70	11	17.5	11	M8x1	1X4	3480	7779
☆ DFIR5010-4	50	10	6.35	72	114	18	171	92	82	11	17.5	11	M8x1	1X4	3898	10325
☆ DFIR6310-4	63	10	6.35	85	131	22	182	107	95	14	20	13	M8x1	1X4	4401	13611
☆ DFIR8010-4	80	10	6.35	105	150	22	182	127	115	14	20	13	M8x1	1X4	4900	17366

SFU Series Specification

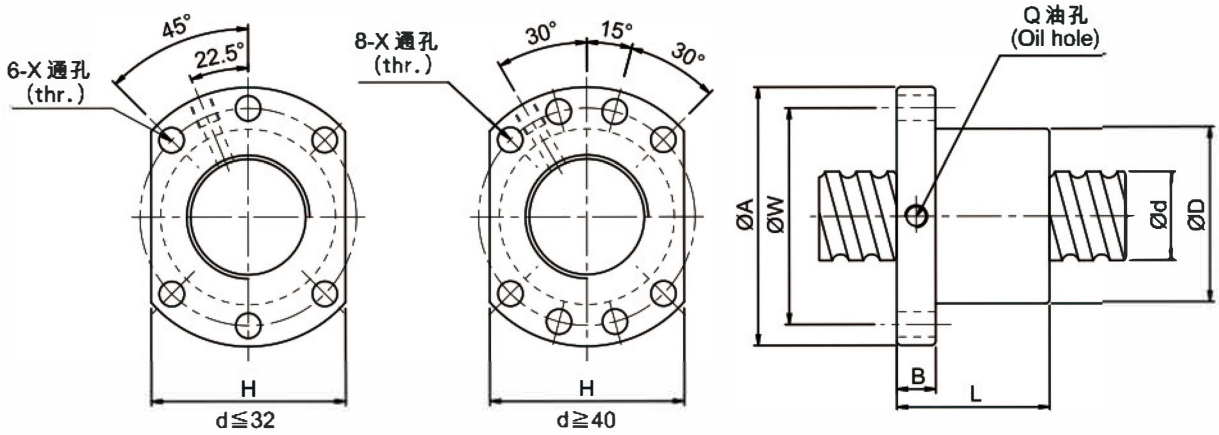

單位: mm

公稱型號 Model no.	軸徑 d	導程 l	珠徑 Da	螺帽尺寸										動額定 負荷 Ca	靜額定 負荷 Coa
				D	A	B	L	W	H	X	Q	n			
☆ SFUR1204-3	12	4	2.5	24	40	10	40	32	30	4.5	M6x1	1x3	451	709	
☆ SFUR1604-3	16	4	2.381	28	48	10	36	38	40	5.5	M6x1	1x3	488	940	
☆ SFUR1605-3		5	3.175	28	48	10	42	38	40	5.5	M6x1	1x3	666	1143	
☆ SFUR1605-4		5	3.175	28	48	10	50	38	40	5.5	M6x1	1x4	888	1525	
☆ SFUR1610-3		10	3.175	28	48	10	57	38	40	5.5	M6x1	1x3	716	1232	
☆ SFUR2004-3		20	4	2.381	36	58	10	42	47	44	6.6	M6x1	1x3	541	1187
☆ SFUR2005-3	5		3.175	36	58	10	42	47	44	6.6	M6x1	1x3	749	1495	
☆ SFUR2005-4	5		3.175	36	58	10	51	47	44	6.6	M6x1	1x4	999	1994	
☆ SFUR2504-3	25	4	2.381	40	62	10	42	51	48	6.6	M6x1	1x3	605	1534	
☆ SFUR2505-3		5	3.175	40	62	10	42	51	48	6.6	M6x1	1x3	839	1935	
☆ SFUR2505-4		5	3.175	40	62	10	51	51	48	6.6	M6x1	1x4	1119	2581	
☆ SFUR2510-3		10	4.762	40	62	10	70	51	48	6.6	M6x1	1x3	1427	2771	
☆ SFUR2510-4		10	4.762	40	62	12	85	51	48	6.6	M6x1	1x4	1903	3695	
☆ SFUR3205-4	32	5	3.175	50	80	12	52	65	62	9	M6x1	1x4	1264	3402	
☆ SFUR3210-3		10	6.35	50	80	12	74	65	62	9	M6x1	1x3	2319	4575	
☆ SFUR3210-4		10	6.35	50	80	12	90	65	62	9	M6x1	1x4	3092	6101	
☆ SFUR4005-4	40	5	3.175	63	93	14	55	78	70	9	M8x1	1x4	1407	4341	
☆ SFUR4010-3		10	6.35	63	93	14	71	78	70	9	M8x1	1x3	2610	5834	
☆ SFUR4010-4		10	6.35	63	93	14	93	78	70	9	M8x1	1x4	3480	7779	
☆ SFUR5010-4	50	10	6.35	75	110	16	93	93	85	11	M8x1	1x4	3898	10325	
☆ SFUR6310-4	63	10	6.35	90	125	18	98	108	95	11	M8x1	1x4	4401	13611	
☆ SFUR6320-4		20	9.525	95	135	20	149	115	100	13.5	M8x1	1x4	7404	19008	
☆ SFUR8010-4	80	10	6.35	105	145	20	98	125	110	13.5	M8x1	1x4	4900	17366	
☆ SFUR8020-4		20	9.525	125	165	25	154	145	130	13.5	M8x1	1x4	8403	25345	

Note: The left thread can be made with ☆

DFU Series Specification

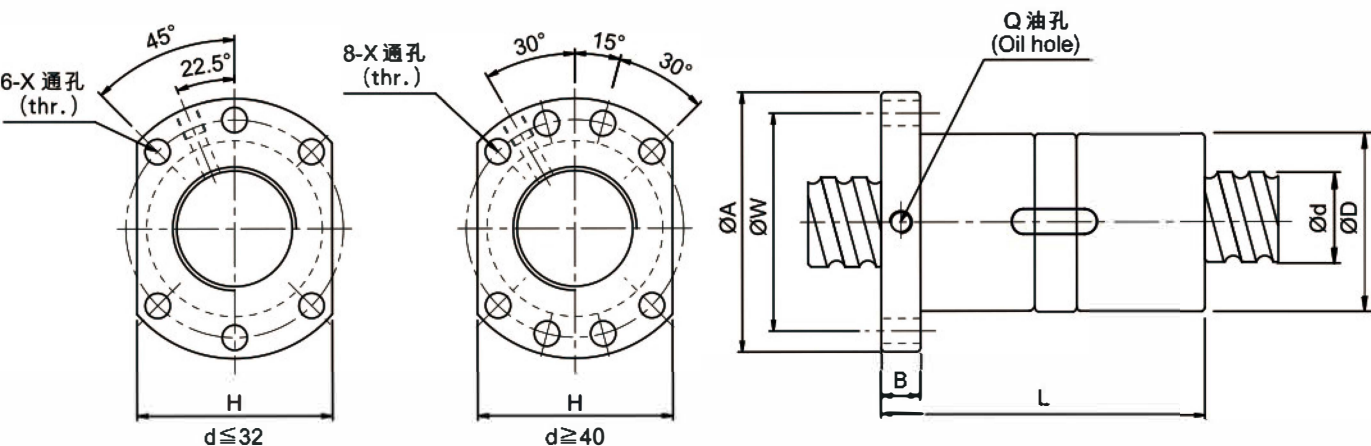

單位: mm

公稱型號 Model no.	軸徑 d	導程 l	珠徑 Da	螺帽尺寸									動額定 負荷 Ca	靜額定 負荷 Coa
				D	A	B	L	W	H	X	Q	n		
DFUR1604-3	16	4	2.381	28	48	10	80	38	40	5	M6x1	1x3	488	940
☆ DFUR1605-3		5	3.175	28	48	10	100	38	40	5	M6x1	1x4	885	1525
☆ DFUR1610-3		10	3.175	28	48	10	118	38	40	5	M6x1	1x3	716	1232
DFUR2004-3	20	4	2.381	36	58	10	80	47	44	6.6	M6x1	1x3	541	1187
☆ DFUR2005-4		5	3.175	36	58	10	101	47	44	6.6	M6x1	1x4	999	1994
DFUR2504-3	25	4	2.381	40	62	10	80	51	48	6.6	M6x1	1x3	605	1534
☆ DFUR2505-4		5	3.175	40	62	10	101	51	48	6.6	M6x1	1x4	1119	2581
☆ DFUR2510-4		10	4.762	40	62	12	145	51	48	6.6	M6x1	1x4	1927	2771
☆ DFUR3205-4	32	5	3.175	50	80	12	102	65	62	9	M6x1	1x4	1264	3402
DFUR3210-4		10	6.35	50	80	12	162	65	62	9	M6x1	1x4	3092	6101
DFUR4005-4	40	5	3.175	63	93	14	105	78	70	9	M8x1	1x4	1407	4341
DFUR4010-4		10	6.35	63	93	14	165	78	70	9	M8x1	1x4	3480	7979
DFUR5010-4	50	10	6.35	75	110	16	171	93	85	11	M8x1	1x4	3898	10325
DFUR6310-4	63	10	6.35	90	125	18	182	108	95	11	M8x1	1x4	4401	13611
DFUR6320-4		20	9.525	95	135	20	290	115	100	13.5	M8x1	1x4	7404	19008
DFUR8010-4	80	10	6.35	105	145	20	182	125	110	13.5	M8x1	1x4	4900	17366
DFUR8020-4		20	9.525	125	165	25	295	145	130	13.5	M8x1	1x4	8403	25345

Note: The left thread can be made with ☆

SFK Series Specification

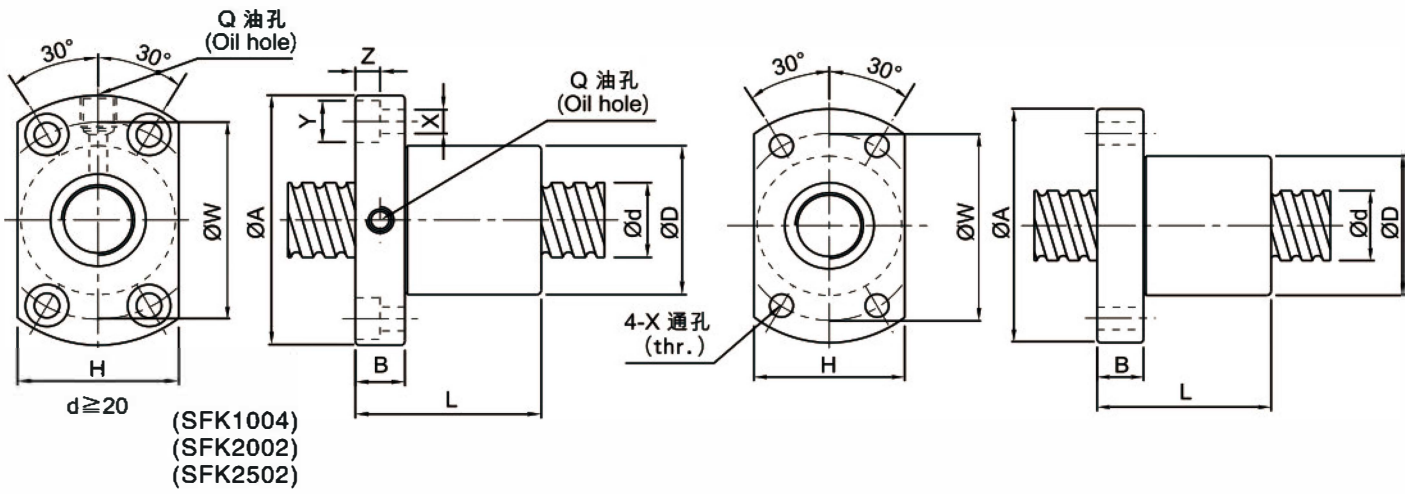

單位: mm

公稱型號 Model no.	軸徑 d	導程 l	珠徑 Da	螺帽尺寸											動額定 負荷 Ca	靜額定 負荷 Coa
				D	A	B	L	W	H	X	Y	Z	Q	n		
SFKR0401	4	1	0.8	10	20	3	12	15	14	2.9	-	-	-	1X2	64	97
SFKR0601	6	1	0.8	12	24	3.5	15	18	16	3.4	-	-	-	1X3	111	224
SFKR0801	8	1	0.8	14	27	4	16	21	18	3.4	-	-	-	1X4	161	403
SFKR0802		2	1.2	14	27	4	16	21	18	3.4	-	-	-	1X3	222	458
SFKR082.5		2.5	1.2	16	29	4	26	23	20	3.4	-	-	-	1X3	221	457
SFKR1002	10	2	1.2	18	35	5	28	27	22	4.5	-	-	-	1X3	243	569
SFKR1004		4	2	26	46	10	34	36	28	4.5	-	-	-	1X3	468	905
SFKR1204		2	1.2	20	37	5	28	29	24	4.5	8	4.5	M6	1X3	334	906
SFKR1205	12	4	2.5	24	40	6	28	32	25	3.5	-	-	-	1X4	454	722
SFKR1202		5	2.5	22	37	8	39	29	24	4.5	-	-	-	1X3	675	1316
SFKR1402	14	2	1.2	21	40	6	23	31	26	5.5	-	-	-	1X3	354	1053
SFKR1602	16	2	1.2	25	43	10	40	35	29	5.5	-	-	M6	1X4	373	1200
SFKR2002	20	2	1.2	50	80	15	55	65	68	6.5	10.5	6	M6	1X6	581	2284
SFKR2502	25	2	1.2	50	80	13	43	65	68	6.5	10.5	6	M6	1X5	540	2381

SCI Series Specification

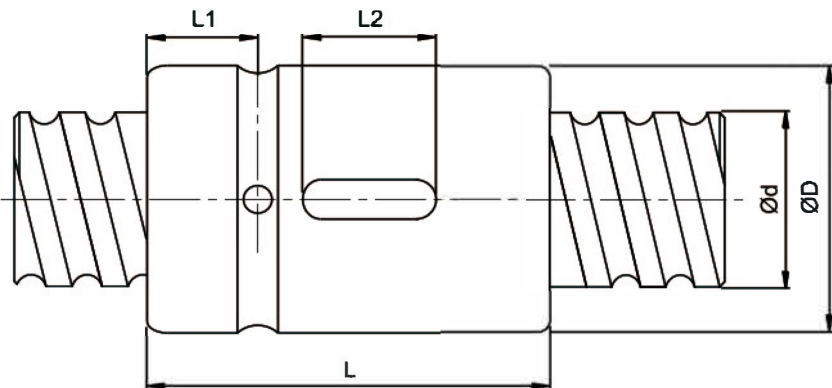
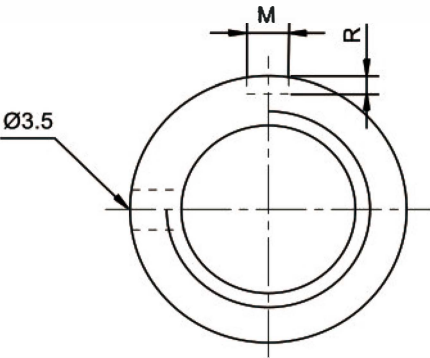

單位: mm

公稱型號 Model no.	軸徑 d	導程 l	珠徑 Da	螺帽尺寸							動額定 負荷 Ca	靜額定 負荷 Coa	剛性 kgf/ µm
				D	L	L1	L2	M	R	n			
SCI01604-4	16	4	2.381	30	40	9	15	3	1.5	1x4	973	2406	32
☆ SCI01605-4		5	3.175	30	45	9	20	5	3	1x4	1380	3052	33
SCI02004-4	20	4	2.381	34	40	9	15	3	1.5	1x4	1066	2987	37
☆ SCI02005-4		5	3.175	34	45	9	20	5	3	1x4	1551	3875	39
SCI02504-4	25	4	2.381	40	40	9	15	3	1.5	1x4	1180	3795	73
☆ SCI02505-4		5	3.175	40	45	9	20	5	3	1x4	1724	4904	45
SCI02510-4		10	4.762	46	85	13	30	5	3	1x4	2954	7295	51
☆ SCI03205-4	32	5	3.175	46	45	9	20	5	3	1x4	1922	6343	52
SCI03210-4		10	6.35	54	85	13	30	5	3	1x4	4805	12208	62
SCI04005-4	40	5	3.175	56	45	9	20	5	3	1x4	2110	7988	59
SCI04010-4		10	6.35	62	85	13	30	5	3	1x4	5399	15500	72
SCI05010-4	50	10	6.35	72	85	13	30	5	3	1x4	6004	19614	83
SCI06310-4	63	10	6.35	85	85	13	30	6	3.5	1x4	6719	25358	95
SCI08010-4	80	10	6.35	105	85	13	30	8	4.5	1x4	7346	31953	109